

GENERAL NOTES:

1. NORTH IS ORIENTED TO GRID NORTH FROM GPS.
2. HORIZONTAL DATUM IS ON NORTH AMERICAN DATUM OF 1983, NAD 83(2011), NEW YORK STATE PLANE COORDINATE SYSTEM EAST ZONE.
3. VERTICAL DATUM IS REFERENCED TO NAVD88 AS SHOWN ON MAP ENTITLED VICTORY MILLS - 42 - GATES AVENUE BOUNDARY & TOPOGRAPHIC SURVEY OF THE LANDS OF RIVERVIEW REALTY LLC PREPARED BY AUSFELD & WALDRUFF LAND SURVEYORS LLP DATED MARCH 21, 2008.
4. CONTOUR INTERVAL = 1 FOOT.
5. INFORMATION SHOWN HEREON IS FROM A GROUND SURVEY CONDUCTED ON 12/27/18 - 12/31/18 SUPPLEMENTED WITH FIELD VERIFIED DATA DIGITIZED FROM A MAP ENTITLED "VICTORY MILLS - 42 GATES AVENUE, BOUNDARY & TOPOGRAPHIC SURVEY OF THE LANDS OF RIVERVIEW REALTY, LLC" PREPARED BY AUSFELD & WALDRUFF LAND SURVEYORS LLP DATED MARCH 21, 2008.
6. TOPOGRAPHIC SURVEY FOR HERKIMER STREET, PRATT STREET AND POND STREET CONDUCTED BY M.J. ENGINEERING AND LAND SURVEYING P.C. MAY 30, 2019 & JUNE 3, 2019

MAP REFERENCES:

1. VICTORY MILLS - 42 GATES AVENUE, BOUNDARY AND TOPOGRAPHIC SURVEY OF THE LANDS OF RIVERVIEW REALTY LLC, PREPARED BY AUSFELD & WALDRUFF LAND SURVEYORS LLP DATED MARCH 21, 2008.

TP#	Existing Ground	Depth	Soil Classification
TP#1	Existing Ground +172.0	0' - 4'	Topsoil
		4' - 8'	Asphalt millings
		8' - 20'	Asphalt millings
		20' - 95'	Broke shale with a little bit of sandy loam
TP#2	Existing Ground +171.0	0' - 13'	Topsoil
		13' - 40'	Sandy Loam
		40' - 80'	Glacial till (Silty loam with Cobbles 1" to 2" and Clay)
		80' - 83'	Brown Clay
TP#3	Existing Ground +169.0	0' - 14'	Topsoil
		14' - 22'	Sandy Loam
		22' - 25'	Ash
		25' - 74'	Glacial till (Silty loam with Cobbles 1" to 2" and Clay)
PT#1	9.25 inches/hour	8.45 inches/hour	7.42 inches/hour
	8.45 inches/hour	8.98 inches/hour	8.5 average (inches/hour)
PT#2	14.25 inches/hour	13.33 inches/hour	11.76 inches/hour
	11.76 inches/hour	11.65 inches/hour	12.7 average (inches/hour)

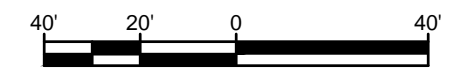

PRELIMINARY DRAWINGS: NOT FOR CONSTRUCTION

SUBMITTAL / REVISIONS					
No.	DATE	DESCRIPTION	BY	REVIEWED BY:	DATE

PROJ. MANAGER: JWVE
 CHIEF DESIGNER: JWVE
 DESIGNED BY: JWVE
 DRAWN BY: APY
 CHECKED BY: JWVE

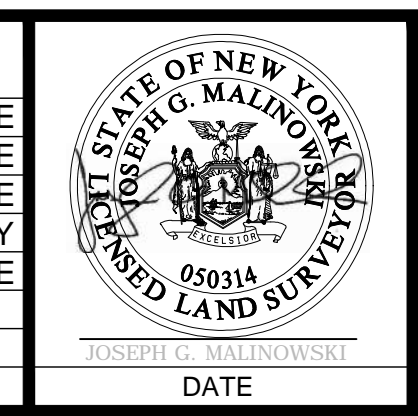

DATE DATE

THE ALTERATION OF THIS MATERIAL IN ANY WAY, UNLESS DONE UNDER THE DIRECTION OF A COMPARABLE PROFESSIONAL, (I.E.) ARCHITECT FOR AN ARCHITECT, ENGINEER FOR AN ENGINEER OR LANDSCAPE ARCHITECT FOR A LANDSCAPE ARCHITECT, IS A VIOLATION OF THE NEW YORK STATE EDUCATION LAW AND/OR REGULATIONS AND IS A CLASS "A" MISDEMEANOR.

Engineering and Land Surveying, P.C.
 1533 Crescent Road - Clifton Park, NY 12065

REGAN DEVELOPMENT
EXISTING CONDITIONS
 42 GATES AVE
 VILLAGE OF VICTORY NEW YORK

SCALE: 1" = 40'
 CONTRACT No.:
 MJ PROJ. No.: 972.32
 DATE: MAY 10, 2019
C-2

10/11/2019
 BY JAMIE EASTON
 SUNNY, 507